

operating instructions

VICTA

LIGHTWEIGHT

COMPACT

MOWER



RUNNING IN

For the first two gallons of fuel, use BP Zoom 25 or an equivalent 25 to 1 fuel oil mixture. Thereafter use a 50:1 mixture. Refer fuel recommendation Page 2.

powered by

VICTA

85 cc TWO STROKE ENGINE

GUARANTEE

Your lawnmower is guaranteed for 12 months from the date of purchase against mechanical defects, faulty workmanship or material. The Guarantee service covers **only** the replacement, repair or adjustment of any part which fails as a result of a fault in manufacture or assembly. Adjustments such as cleaning spark plugs, carburettor, magneto points or filter elements are not covered by the Guarantee. Defective parts will be replaced or serviced by Victa Limited or their authorised representatives without charge for labour or material subject to the following conditions:

CONDITIONS OF GUARANTEE

1. Fair wear or damage from misuse is not covered by the Guarantee.
2. Blades and Spark Plugs are not covered by the Guarantee.
3. Two-stroke Engines run without correct oil in the fuel are not covered by Guarantee. Fuel and oil to be used according to the Manufacturer's instructions.
4. Transport of the mower to and from the manufacturer, their agents or dealers, to be paid for by the mower owner.
5. Repairs carried out other than by Authorised Victa Service Repairers cancels the Guarantee.
6. The use of other than Genuine Victa Spare Parts cancels the Guarantee.
7. The Guarantee cover is limited to 60 days on mowers used commercially.

The above Guarantee or warranty is in place of every other warranty or condition whether express or implied as to the quality of fitness of the lawnmower.

FOR YOUR PROTECTION

Please fill in the engine number and date of purchase for your own record and protection.

ENGINE No.: DATE OF PURCHASE:

FUEL RECOMMENDATION

IMPORTANT: THIS ENGINE IS DESIGNED TO OPERATE ON A 50:1 FUEL/OIL MIXTURE. Victa recommends **BP Zoom 50** (which is coloured purple) or an equivalent premixed 50:1 fuel.

An acceptable alternative fuel is BP EZIMIX or an equivalent high grade two-stroke oil mixed in the ratio of 1 part oil to 50 parts of standard petrol. (Super may be used if standard is unavailable.) Supplied with your mower is a Victa Fuel Can; to obtain the correct fuel/oil mixture measure 100 ml (3½ fl. oz.) of oil into the fuel can, add to the fuel can 5 litres (1 gallon) of standard petrol and ensure that the oil and fuel are thoroughly mixed.

Care must be taken to ensure that all utensils are clean and that no dirt or foreign matter is permitted to contaminate the fuel/oil during the mixing process.

WARNING: Do not use Multi-grade automotive oils mixed in the fuel of a two-stroke engine as this will cause the service life of the engine to be greatly reduced.

The ability of this engine to run with less oil than normal in the fuel mixture is due to its low running temperature. Use of more oil in the mixture will cause excessive smoke emission and shorten the service life of the spark plug; it will not, however, damage the engine components.

ENGINE SPECIFICATIONS

Fuel Tank Capacity	0.85 litres
Spark Plug	Part No. HA25299A
(Champion UJ12 or equivalent)	
Spark Plug Gap	0.76 mm (0.030")
Magneto Points Gap	0.61 mm (0.024")
E. Core to Flywheel Gap	0.25 mm/0.38 mm (0.010"/0.015")

MOWER SAFETY

WARNING: DISCONNECT SPARK PLUG LEAD FROM SPARK PLUG AND WEDGE THE TERMINAL BETWEEN CYLINDER HEAD FINS. ENSURE THROTTLE CONTROL IS SET IN "STOP" POSITION TO ELIMINATE FIRE RISK BEFORE ATTEMPTING TO CLEAN MOWER, FIT NEW BLADES, OR CARRY OUT ANY MAINTENANCE OR REPAIRS.

1. Know your controls. Read the instructions carefully. Learn how to stop the engine quickly in an emergency. Move throttle control lever to "STOP".
2. Do not allow children or people unfamiliar with these instructions to use the mower.
3. Before using, always visually inspect to see that blades, blade bolts and cutter assembly are not worn or damaged. Replace worn or damaged blades and bolts in sets to preserve balance.
4. Check all nuts, bolts and screws often; always be sure the mower is in safe operating condition. Use only replacement parts made and guaranteed by Victa.
5. Make sure the lawn is clear of sticks, stones, bones, wire and debris before you mow. They could be thrown by the blades.
6. Do not mow whilst people, especially children or pets are in the mowing area.
7. Add fuel BEFORE starting engine. Avoid spilling petrol and do not fill tank while engine is running or while you are smoking.
8. Never use the mower unless the guards provided by the manufacturer, are in position.
9. Do not mow barefoot or in open sandals. Wear long trousers and heavy shoes.
10. It is advisable to wear suitable eye protection when operating a mower.
11. Start the engine carefully with feet well away from the blades.
12. Do not operate engine in a confined space where exhaust fumes (carbon monoxide) can collect.
13. Stop the engine whenever you leave the mower, even for a moment.
14. Stop the engine before pushing mower across drives, walks or roads.
15. Never lift or carry a mower when the engine is running.
16. On slopes or wet grass, be extra careful of your footing. Always mow across slopes not up and down them.
17. Never cut grass by pulling the mower towards you. You might slip and pull the mower on top of yourself.
18. Do not overspeed the engine or alter governor settings. Excessive speed is dangerous and shortens mower life.
19. At the conclusion of mowing move throttle control to "Stop" position and turn off fuel. IT IS NOT RECOMMENDED THAT ENGINE BE RUN UNTIL CARBURETTOR IS DRY.
20. Store fuel in a cool place in a container specifically designed for the purpose. In general, plastic containers are unsuitable.

OWNERS ARE RECOMMENDED IN THEIR OWN INTERESTS, TO ENTRUST ALL MAINTENANCE AND REPAIR WORK TO A VICTA SERVICE CENTRE, AS SUCH CENTRES ARE EQUIPPED WITH THE PROPER TOOLS AND STAFFED BY SPECIALLY TRAINED MECHANICS WHO WORK UNDER MANUFACTURERS' INSTRUCTIONS.

A COMPREHENSIVE WORKSHOP MANUAL IS AVAILABLE FOR THE OWNER WHO WISHES TO CARRY OUT THE MAINTENANCE ON HIS OWN MOWER.

VICTA COMPACT MOWER OPERATING CONTROLS

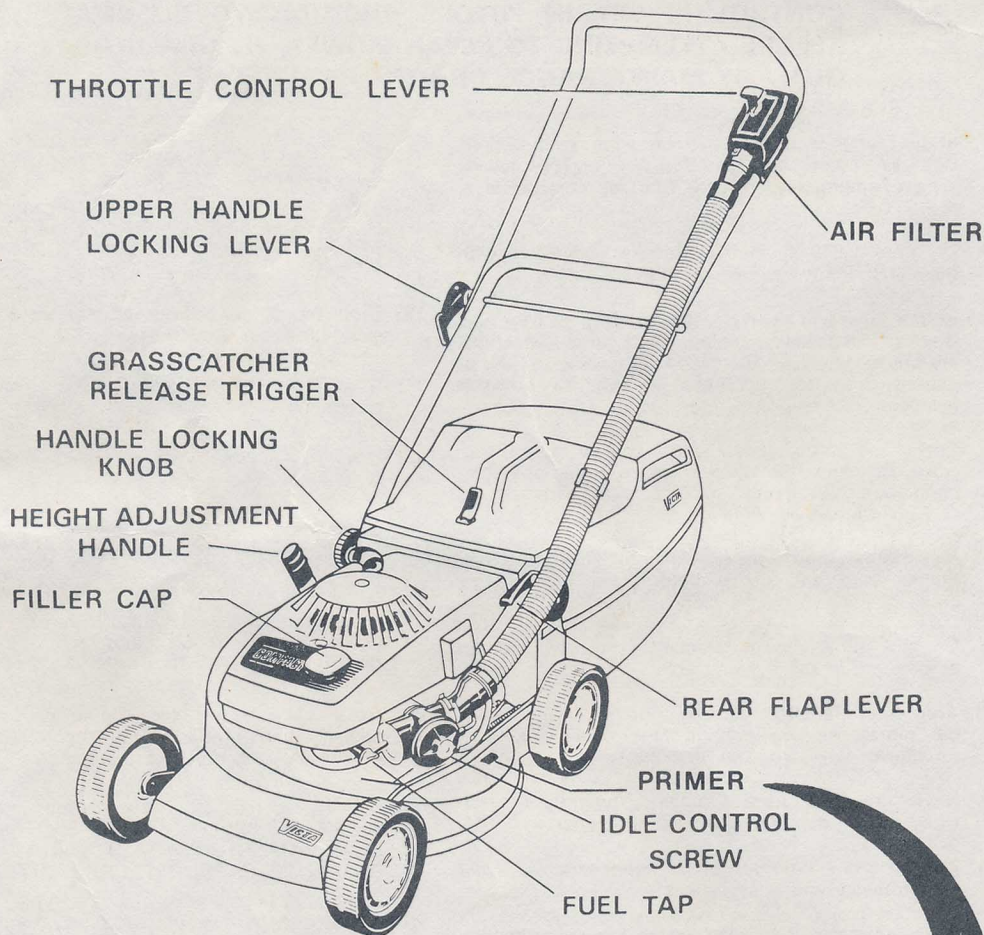

COLD START PRIMER

**PRESS PRIMER SHARPLY
ONCE ONLY.**

**VENT HOLE MUST BE COVERED
BY FINGER TIP WHEN PRESSED.**

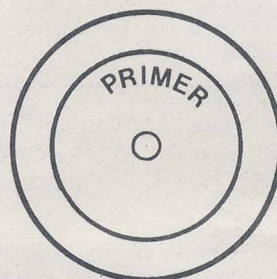

TO START ENGINE

STARTING PROCEDURE

(Engines fitted with cold start primer.)

A. COLD START: (A new engine, or the first start of the day):—

1. Turn fuel tap to ON.
2. Position throttle lever in COLD START position.
3. Press priming bulb **once only** (see diagram).
4. Pull starter handle briskly.

B. HOT START: (Engine has been running before on that day):—

1. Turn fuel tap to ON.
2. Position throttle lever in HOT START position.
3. Pull starter handle briskly.

NOTE: If the engine does not start first pull, one press on the priming bulb will assist. Leave throttle lever in HOT START position.

IMPORTANT: More than one press on the priming bulb, or holding the bulb pressed in, will result in **excess** fuel supply to the engine. If this **has** occurred, set the throttle lever to HOT START and pull starter handle briskly several times. The Zip Start valve will allow the engine to clear itself of the excess fuel.

THROTTLE CONTROL

The throttle control has five (5) settings, STOP, COLD START, SLOW, HOT START and GRASSCATCHING. These positions are marked on the air filter body.

Stand to right-hand side of the mower with feet well clear. Brace mower, by holding mower handle with left hand. Take hold of starter grip with right hand and pull smartly towards you. While still holding starter grip, allow cord to rewind. Repeat pulling action if necessary.

After starting a cold engine, allow it to run for approximately fifteen (15) seconds with the throttle lever remaining in the "COLD START" position to ensure that the engine will not stall when beginning to cut grass.

Always set the lever at "GRASSCATCHING" when mowing grass so that the engine will run at its governed speed to achieve best results.

NOTE: This engine is equipped with a ZIP starter. This is an automatic decompression unit which acts as a compression release during the early stage of the starting operation. Traces of oil which may appear on the baseplate are the result of the normal operation of the decompressor and do not affect the performance of the engine.

TO STOP ENGINE

To stop engine at any time move throttle control lever to "**STOP**" position. This will immediately operate the cut-out switch in the ignition circuit.

At the conclusion of mowing move the throttle control lever to "**STOP**" position and turn off the fuel. IT IS NOT RECOMMENDED THAT THE ENGINE BE RUN UNTIL THE CARBURETTOR IS DRY AS THIS LEAVES THE ENGINE DRY AND EXTREMELY HOT AND CAN ONLY LEAD TO HARD STARTING.

After the engine has stopped, set the throttle control lever to the "Grasscatching" position before folding the handles or before storing the mower to avoid undue strain on the throttle cable.

RUNNING IN

By the time the first 10 litres (two gallons) of fuel has been used, the engine will be run in. If possible, avoid cutting heavy growth during this period. Engine performance will increase during this run in period.

OPERATING INSTRUCTIONS

HANDLE LOCKING

The double-fold handle is locked into position on the baseplate by two hand-operated screwed knobs. At the second fold, the joint is locked by a lever which incorporates a cam.

Raise the handles into the operating position and first lock the upper joint by swinging the lever downwards. This action will simultaneously engage the ends of the lower handle in the slots in the baseplate where they must be secured by tightening the locking knobs by hand.

To fold the handles, first release the lower locking knobs and then unlock the upper fold lever. The lower handle ends will then spring out of engagement on the baseplate.

HEIGHT ADJUSTMENT

The height adjustment lever is operated by pulling slightly away from the baseplate to release it from engagement in the height adjustment segment. It may then be moved forward to raise; or backwards to lower the

mower as desired. Release the lever for positive engagement.

DO NOT ATTEMPT TO CUT TOO LOW. THIS WILL TEND TO TEAR YOUR LAWN.

SPARK PLUG LEAD

Remove the nut from the spark plug and slip the brass terminal on the high tension lead onto the spark plug. Replace the nut and then fit the rubber insulator snugly over the spark plug.

FUEL

Ensure that the fuel tank is filled with the correct fuel. See fuel specification, Page 2.

Turn the fuel tap anti-clockwise to the "ON" position where a distinct click will be felt and the lever will point downwards and slightly past vertical. Pause for approximately ten (10) seconds to allow the fuel to reach and fill the carburettor.

MOVE THE CUTTING HEIGHT CONTROL LEVER TO THE HIGH POSITION BEFORE STARTING THE ENGINE.

OPERATING INSTRUCTIONS

TO FIT GRASSCATCHER

Place the catcher on the ground behind the mower. See Fig. 1.

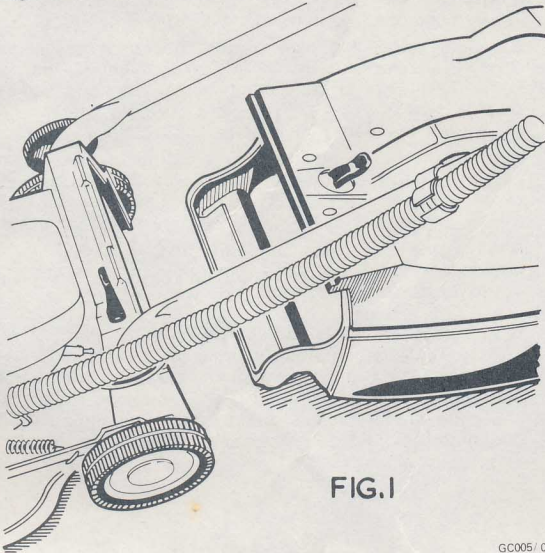

FIG.1

GC005/0

TO REMOVE GRASSCATCHER

Stand to one side of the mower and take hold of the catcher handle. With the thumb, depress the catcher release trigger and withdraw the catcher rearwards and upwards. The rear flap will automatically close after the catcher is clear of the baseplate.

Stand to one side of the mower and with one hand, partially raise the rear flap by means of the flap lever. See Fig. 2.

With the other hand, reach through the handles, below the crossbar and lift the catcher so that the tongue on the catcher is under the flap and over the rear axle. See Fig. 2.

Lift the catcher further forward and locate the mouth of it over the the ridge across the top of the rear of the baseplate. Fully depress the flap lever forward to lock the flap inside the catcher and to lock the catcher in position ready for mowing.

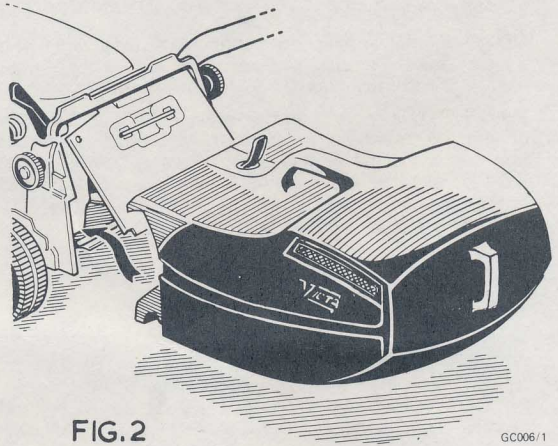

FIG.2

GC006/1

GRASS EJECTOR CHUTE (Optional Extra)—STOP ENGINE TO FIT.

The grass ejector chute, which is an optional extra, should be purchased if you use the mower without a catcher at any time. It is fitted over the rear aperture by pushing the rear flap lever forward until the flap is raised to the horizontal position. See Fig. 1. The chute is then inserted under the flap so that the tongue illustrated in Fig. 1 engages in the slot shown in Fig. 2 in the rear flap. The weight of the flap holds the ejector chute in position.

With the ejector chute on the mower, the discharge from the rear chute is deflected to the left of the operator. The mower may then be used on a high cutting height setting to mow long or heavy growth where the use of the grasscatcher is undesirable. Alternatively, when growth conditions are light and it is desired to spread the cuttings over the lawn as a mulch, the ejector chute should be used.

Fig. 1

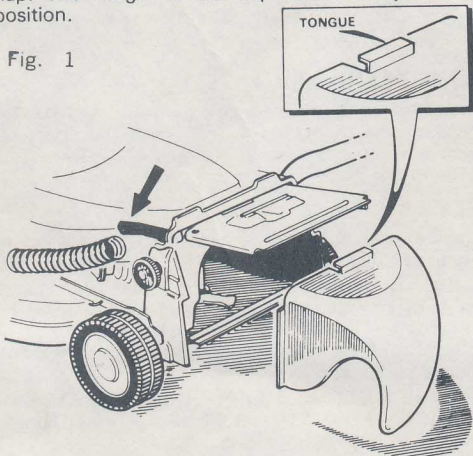
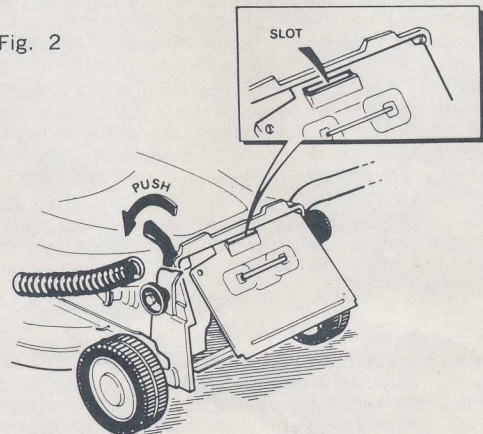

Fig. 2



MAINTENANCE AND TECHNICAL INFORMATION

WARNING: Disconnect spark plug lead from spark plug and wedge the terminal between cylinder head fins. Ensure throttle control is set in "STOP" position to eliminate fire risk before attempting to clean mower, fit blades, or carry out any maintenance or repairs.

THROTTLE CABLE ADJUSTMENT

If at any time the ignition cut out does not stop the engine when the throttle control lever is moved into the STOP position, the throttle cable must be adjusted. The procedure to adopt is as follows:—

Move the throttle control lever to the top end of its slot, past STOP, and then slacken off the adjusting screw. See Fig. 1.

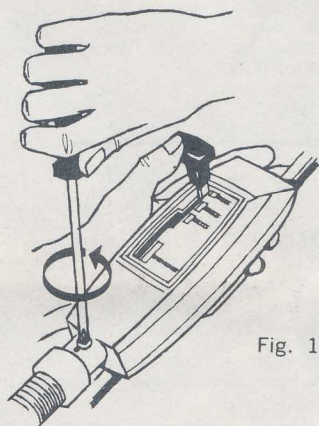

Fig. 1.

While holding light pressure against the throttle control lever, force the screw downwards until the lever is pulled approximately 1/10" from the end of the slot. Secure the adjusting screw at this position. See Fig. 2.

Start the engine and check that ignition cut out occurs after the throttle control lever has passed the COLD START position but before it reaches the upper end of the slot. Re-adjust as necessary.

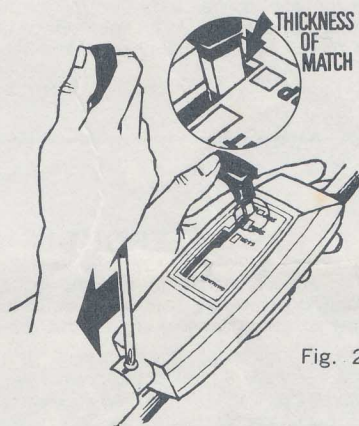

Fig. 2.

BLADE REPLACEMENT

Use Blade and Tension Washer Set Part No. CA09306S

Use Blade Bolt, Nut and Washer Set Part No. CA09277S

TO REMOVE BLADES

Stop engine and turn fuel tap "Off", disconnect spark plug lead and wedge the terminal between cylinder head fins. Ensure throttle control is set in "Stop" position to eliminate accidental starting and fire risk, before attempting to replace blades. Remove grasscatcher if fitted and turn mower on its side, with cutting height adjustment handle side up.

Turn bladeholder (3) until blade bolt (6) is in grass chute area of baseplate.

Unscrew nut (1) with supplied spanner, holding bolt head into bladeholder (3) to prevent bolt (6) turning. The blade (5) can now be removed.

TO FIT BLADES

Ensure the order of assembly is correct (see illustration).

Fit bolt (6) to blade (5) from the recessed side. Locate the blade tension washer (4) over bolt (6) inserting the washer lugs into the blade). Insert bolt (6) through bladeholder (3) from the working side, fit flat washer (2) and securely tighten nut (1).

CAUTION: Never fit onr new blade only—always replace the pair of blades. This will ensure correct engine balance. It is not necessary to remove the bladeholder.

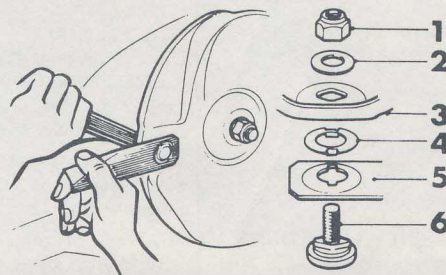

NOTE: For a blade to be correctly fitted, the blade itself must be tight and yet if pressure is applied the blade must be able to move.

MAINTENANCE AND TECHNICAL INFORMATION

AIR FILTERS

Prise the cap off the air filter body, remove the filter element and clean it by slapping on the palm of your hand. Do not use compressed air for cleaning nor wash the element in any liquid. Examine the element for cuts, tears or splits and replace it if damaged in any way.

Remove the upper snorkel adaptor from the lower end of the air filter body and examine the interior of the snorkel for signs of dust. If any dust is detected inside the snorkel, then the filter element **MUST BE REPLACED**.

Use replacement part number AF07282A.

IDLE ADJUSTMENT

The carburettor on this mower is fitted with an idle control screw as shown in the illustration on Page 4. After the initial "Run In" period the idling speed may vary. To correct idling speed, turn the idling screw on the carburettor cap in the direction as indicated by the arrows until a satisfactory idling speed is obtained. Once having been corrected the idle speed should remain stable.

CLEANING U/SIDE OF MOWER

Stop engine and turn fuel tap "Off". Disconnect spark plug lead and wedge the terminal between cylinder head fins. Ensure throttle control is set in "Stop" position to eliminate fire risk, before attempting to clean mower. The underside of your mower should be cleaned to remove clogged dirt or grass which if allowed to build up will affect the grasscatching performance. It should always be cleaned immediately after mowing, especially if an area has just been dressed with sulphate of ammonia or fertiliser, to prevent baseplate corrosion.

A hose may be used on the underside of your mower only and special care must be taken **NOT** to get water into the engine area of your mower, as damage may be done to the magneto, or water could get into the fuel system. If it is cleaned regularly the baseplate remains easy to clean, because the dirt and grass does not get a chance to clog.

NOTE: When mowing in dusty conditions ensure the area is slightly watered beforehand to eliminate dust.

TROUBLE SHOOTING CHART

WARNING: Disconnect spark plug lead from spark plug and wedge the terminal between cylinder head fins. Ensure throttle control is set in "STOP" position to eliminate fire risk before attempting to clean mower, fit blades, or carry out any maintenance or repairs.

Note: In two-stroke engines generally, difficult starting and erratic running is most often caused by dirty spark plugs. If fitting a clean spark plug of the correct type which is known to be functioning, does not restore the engine to proper operating condition, the problem may be solved from the following chart.

PROBLEM	POSSIBLE CAUSE	CORRECTION
DOES NOT START	Dirty Spark Plug. Out of fuel. Stale fuel left in tank from last season. Water in fuel tank. Throttle Lever in incorrect position. Spark Plug leads not connected. Ignition Cut-Out still in contact.	Clean or replace. Refill tank with correct fuel. Start at "COLD START." Drain and refill tank with correct fuel. Drain and refill tank with correct fuel. Refer instructions Page 5. Refer instructions Page 5. Push Throttle Control Lever to "Grasscatching" before setting at "Cold Start."
LOSS OF POWER	Dirty Spark Plug. Dirty air cleaner Cartridge. Too low height adjustment. Caked on dirt and grass under baseplate restricts blades.	Clean or replace. Clean or replace—Refer Page 8. Raise cutting height.
POOR CUT	Blades worn or damaged. Blade disc loose. Slow running.	Clean—Refer Page 8. Renew. Tighten nut. Refer "Loss of Power."
EXCESSIVE VIBRATIONS	Build up of grass and dirt on upper surface of blade disc. Blades out of balance. Bent blade. Looseness of assembly.	Clean. Renew. Renew. Check all nuts for tightness.

CHASSIS ASSEMBLY

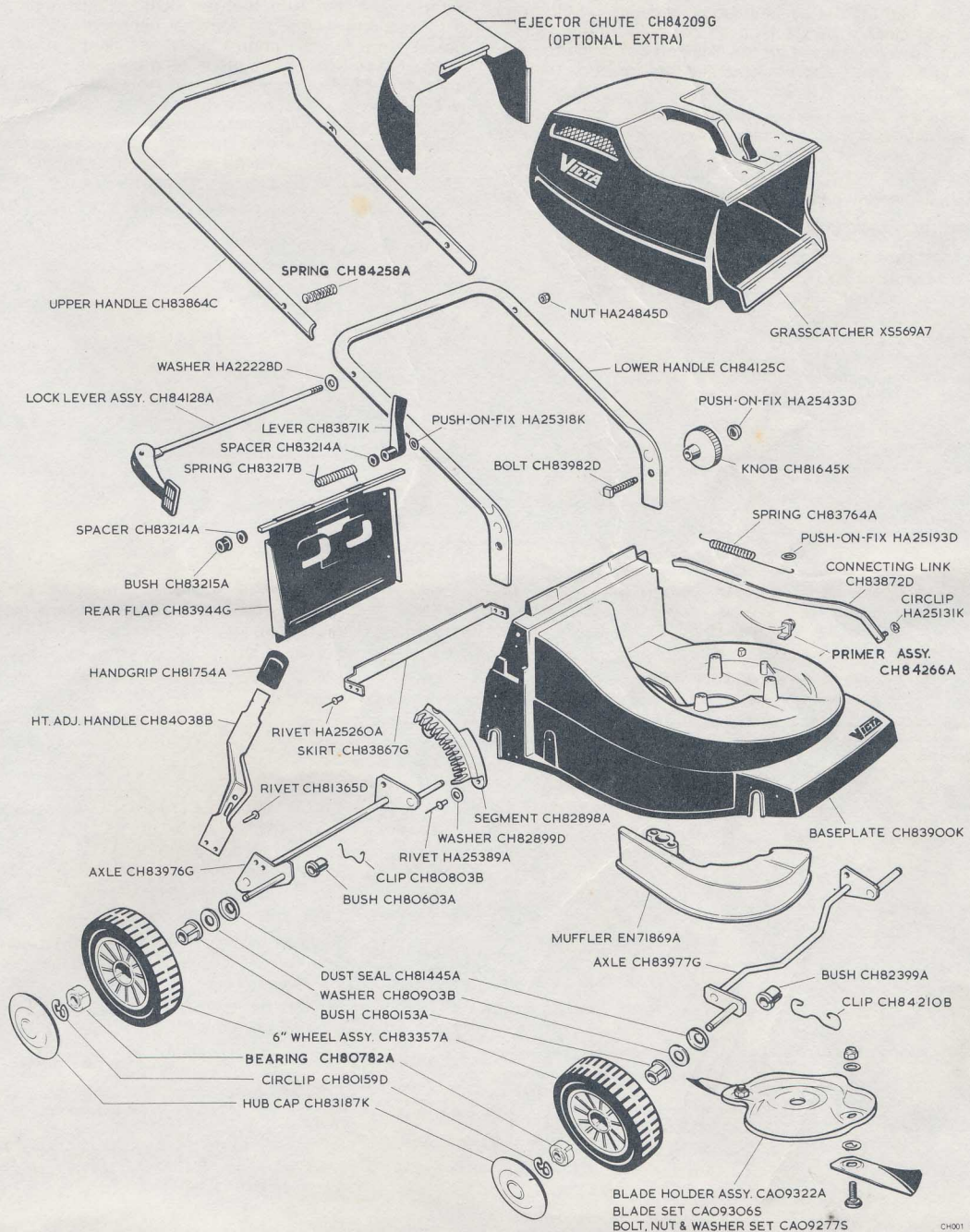

CH001 1

When ordering replacement parts please quote the numbers shown above.

ENGINE ASSEMBLY

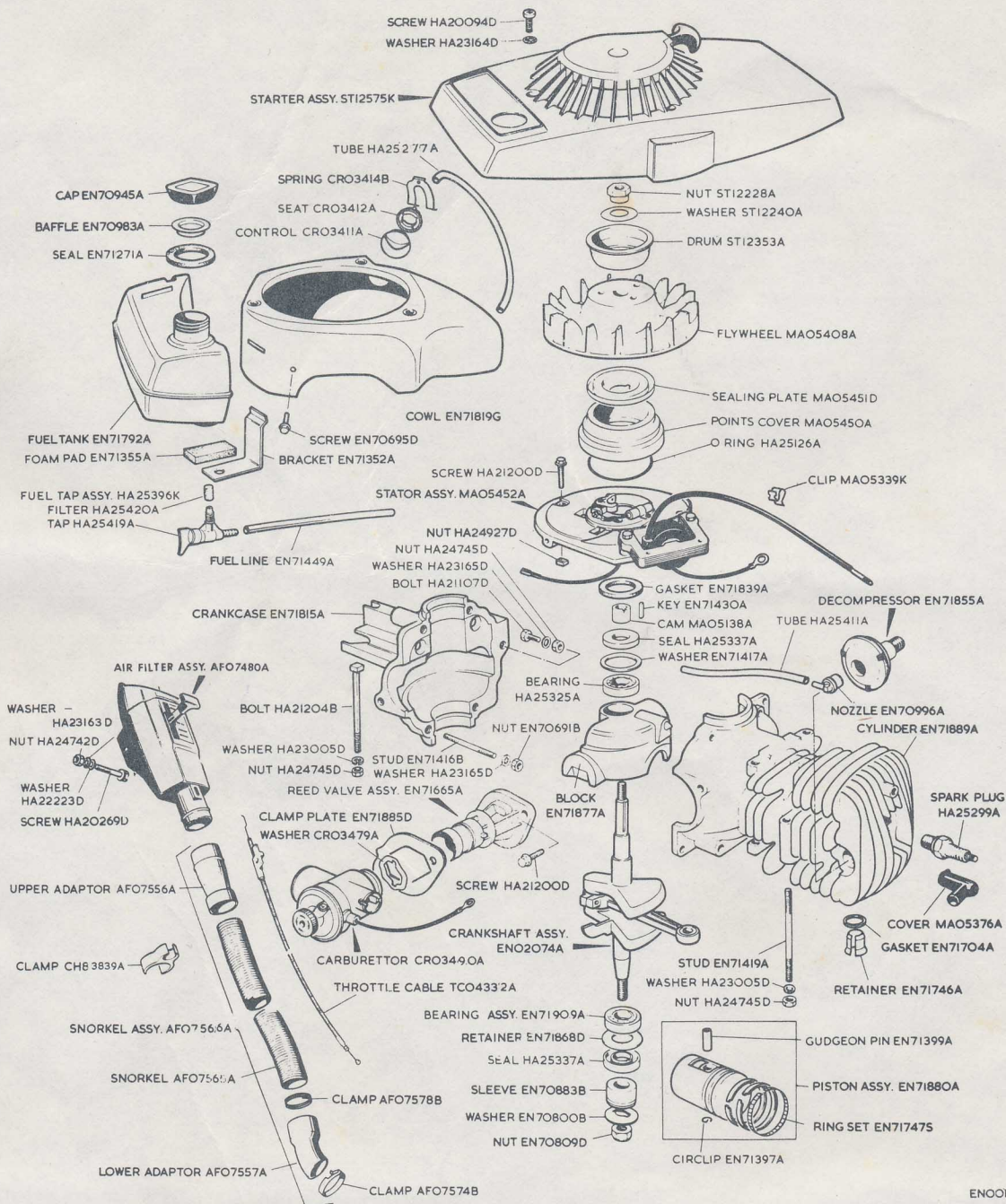

EN001/I.

When ordering replacement parts please quote the numbers shown above.

ENGINE ASSEMBLY

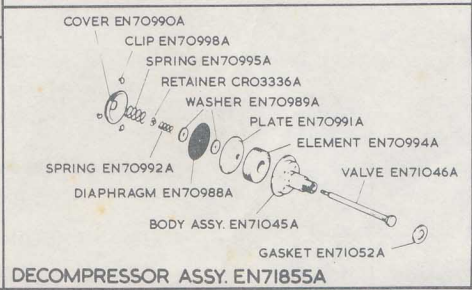
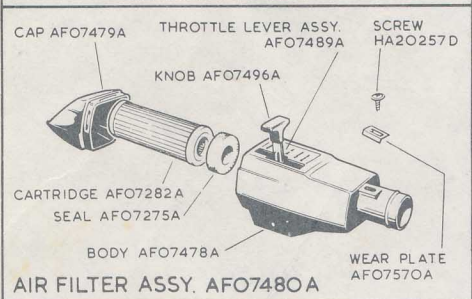
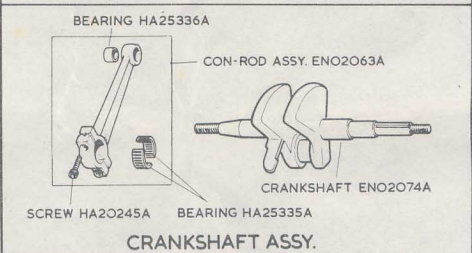
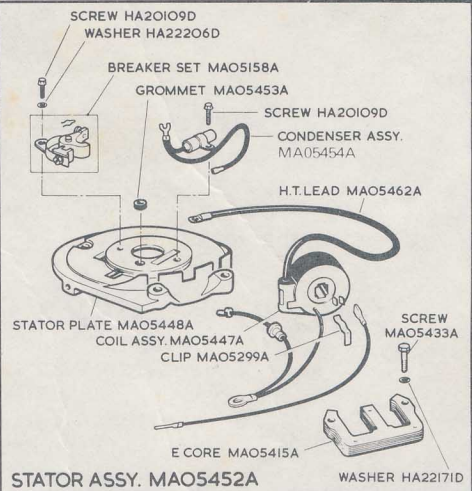
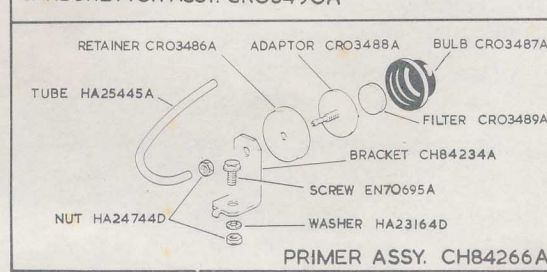
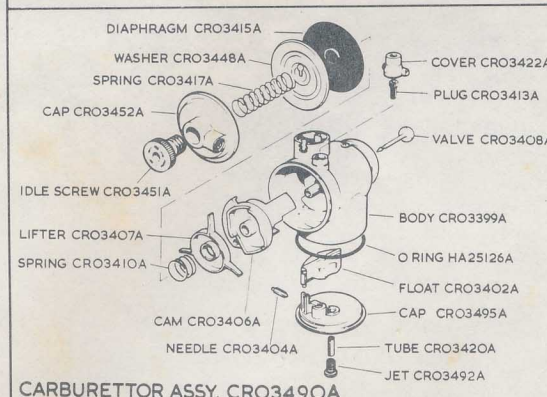
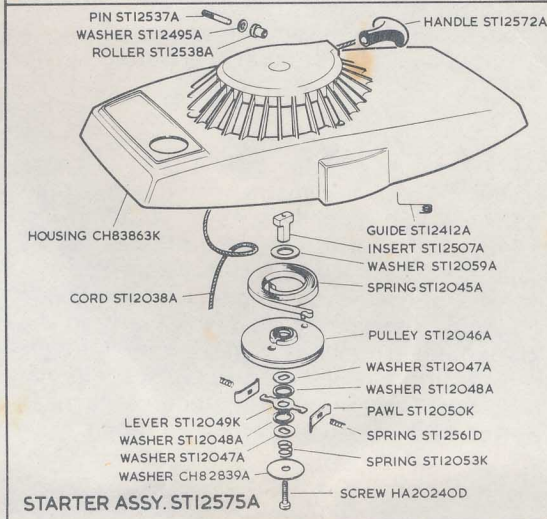

When ordering replacement parts please quote the numbers shown above.

What You Should Know About

VICTA

Service and Replacement Parts

Victa backs every product it makes with an After Sales Service Network that extends to 60 countries throughout the world. No matter where an owner of a Victa product may be or move to, Victa parts and service are literally as close as the telephone.



Replacement Parts

Genuine Victa Replacement Parts are made to the same high standard of quality as the original parts fitted to your mower. The 14 gauge blades fully comply with the requirements set by the Standards Association of Australia for safer mowing.

Victa replacement parts are easily identified on Victa Blade Bars at retailers throughout Australia by the trade mark on the multi-coloured skin packs with the part numbers clearly marked (refer Pages 9, 10 and 11). Victa parts are stocked in different coloured packs to help you select the part you want. Chassis parts are in maroon packs, engine parts in yellow, starter parts in blue, carburettor and magneto parts in orange.

Service

Skilled After Sales Service is always available on Victa mowers throughout Australia. For any service or parts queries, telephone your nearest Victa office or Victa Service Centre. They are all listed in the appropriate telephone directory.



N.S.W.

318 HORSLEY ROAD, MILPERRA, N.S.W., 2214
TELEPHONE: 77-0601

Victoria

WHITE STREET, MARIBYRNONG, VIC., 3032
TELEPHONE: 318-2111

Qld.

95-103 HYDE ROAD, YERONGA, QLD., 4104
TELEPHONES: 48-9711, 48-5171

Nth. Qld.

Cnr. YEATMAN & SOMER STS., HYDE PARK, TOWNSVILLE,
N. QLD., 4812 TELEPHONE: 72-2188

S.A.

39-45 DEEDS ROAD, NORTH PLYMPTON, S.A., 5037
TELEPHONE: 294-2055

W.A.

359 SCARBOROUGH BEACH RD., OSBORNE PARK, W.A., 6017
TELEPHONE: 24-5055

Tasmania

25. TASMA STREET, HOBART, TAS., 7000
TELEPHONE: 34-7722

COPYRIGHT

PRINTED IN AUSTRALIA