

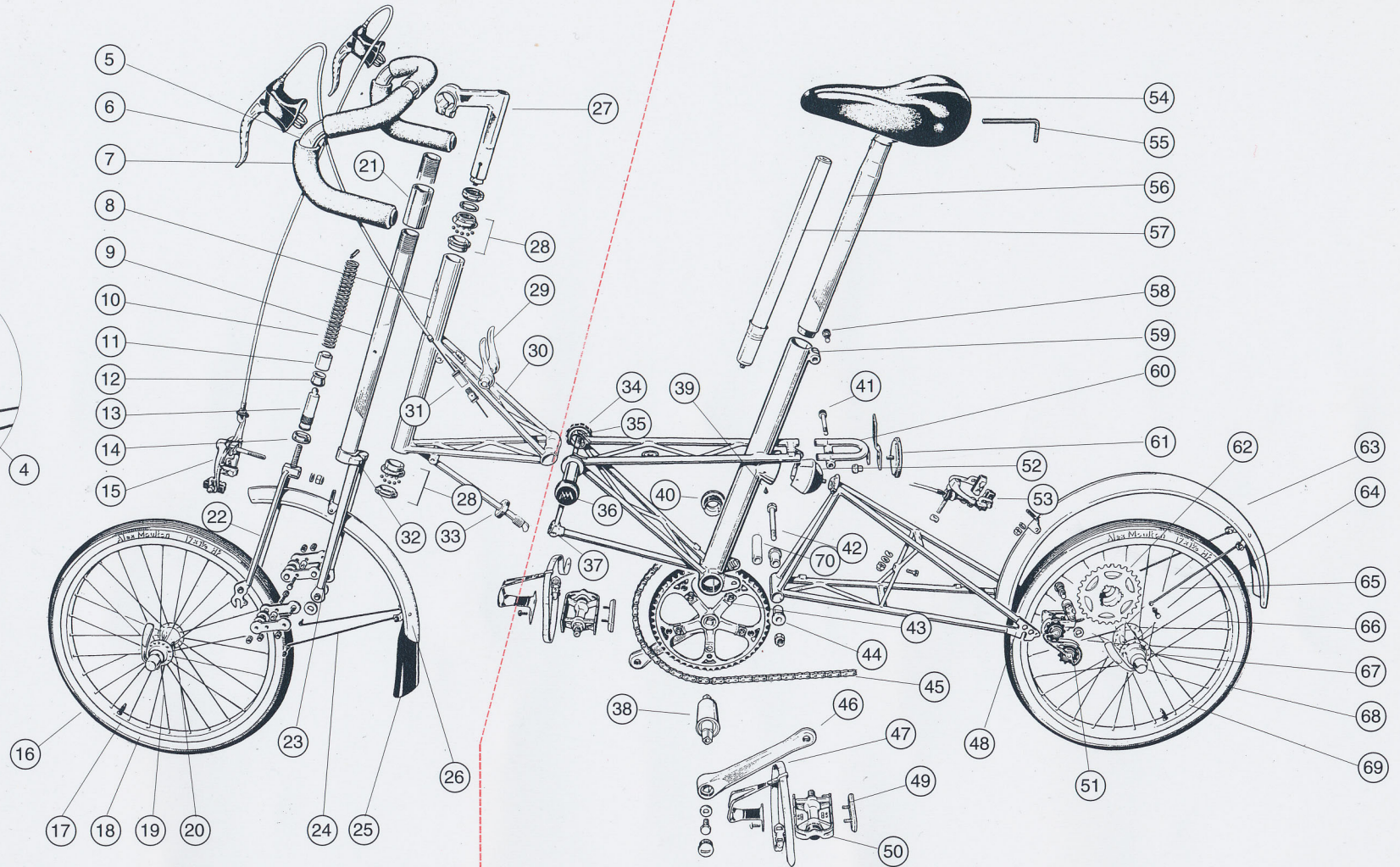

Bradford on Avon
Wiltshire, BA15 1AH
England

Telephone: 01225-865895
Fax: 01225-864742

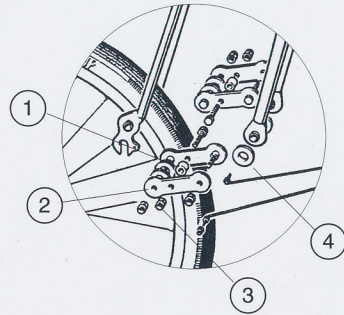

Alex Moulton Bicycles

parts identification numbers

- | | | | | | |
|--------------------------------|-----------------------|------------------------------|-------------------------|--------------------------|---------------------------|
| 1 Leading Link Centre Spacer | 13 Height Adjuster | 25 Mudguard Flap | 34 Kingpin Knob R/H | 46 Crank Arm | 58 Seat Clamp Bolt |
| 2 Leading Link Plate | 14 Bump Stop Washer | 26 Front Mudguard | 35 Kingpin | 47 Pedal Toe Clip | 59 Seat Clamp |
| 3 Leading Link Locknut | 15 Front Brake | 27 Handlebar Stem | 36 Kingpin Knob L/H | 48 Rear Triangle Dropout | 60 'U' Bracket |
| 4 Leading Link Friction Washer | 16 Tyre | 28 Headset | 37 Hook Joint | 49 Pedal Reflector | 61 Rear Reflector |
| 5 Handlebar | 17 Rim | 29 Gear Levers | 38 Bottom Bracket | 50 Pedal | 62 Rear Cassette |
| 6 Brake Lever | 18 Tube | 30 Gear Lever Mounting Plate | 39 Self-Tapping Screw | 51 Rear Derailleur | 63 Rear Mudguard |
| 7 Handlebar Grip | 19 Spoke | 31 Cable Connector | 40 Bottom Bracket Cup | 52 Rear Suspension Unit | 64 Tyre |
| 8 Headtube Badge | 20 Front Hub | 32 Fork Crown | 41 Day Bag Carrier Bolt | 53 Rear Brake | 65 Rear Mudguard Stay |
| 9 Steering Column | 21 Long Column Spacer | 33 Hook joint Locknut | 42 Pivot Bolt | 54 Saddle | 66 Spoke |
| 10 Coil Spring | 22 Stirrup | | 43 Crankset | 55 Allen Key | 67 Rear Hub |
| 11 Nylon Guide Bearing | 23 Front Fork End | | 44 Pivot Bush | 56 Seat Post | 68 Tube |
| 12 Wiper Seal | 24 Mudguard Stay | | 45 Chain | 57 Pump | 69 Rim |
| | | | | | 70 Pivot Bolt Spacer Tube |